

Kentucky Log a Load for Kids



HELP KCH SEE KIDS WHERE THEY ARE!

- ❖ 1 in 4 Kentucky kids doesn't have a pediatrician in their home county.
- ❖ Poverty, physician shortages, and transportation issues all require KCH to have a presence for kids & their families close to home.
- ❖ Pediatric cardiology, specialty clinics, general pediatrics, mental health services and more can be provided on a KCH Mobile Clinic with the help of funding from KFIA and Log a Load for Kids.

We can give kids around Kentucky the care they need today – your support will make the difference and help KCH put a mobile clinic on the road!

SUPPORT KCH KIDS TODAY!

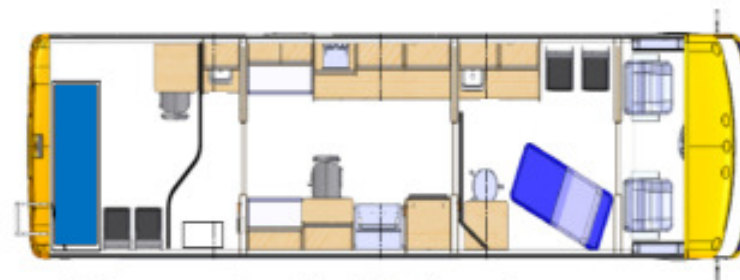

Multi-purpose Exam Room

Triage/Reception Room

Exam Room 1

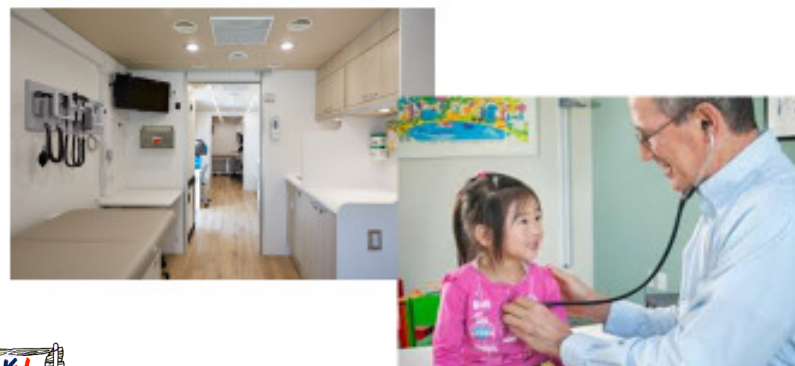

We are currently raising funds for the Kentucky Children's Hospital (KCH) Mobile Clinic as explained above. We have committed \$100,000 for the next 5 years in hopes to get this clinic and others on the road to rural Kentucky areas to provide care to those in need.

Kentucky Log a Load for Kids donations go to the Kentucky Children's Hospital in Lexington. Since 1997 the program has donated over \$800,000 for support of care for sick children and funding of a variety of projects at the hospital. The program constructed two trees in the Treehouse Playroom and the Adolescent Lounge areas of the hospital. The program has also funded two research endowments - one for heart disease and the other for health education that will work to prevent childhood diseases and work with special needs children. These endowments have contributed \$500,000 to the hospital. We are proud to have an area of the hospital named the Log a Load for Kids Child Life Area when we raised \$200,000 for a renovation project. In 2020, we provided \$25,000 for goggles specialized for an MRI screening and helping children remain calm during the screening.